

**Cambridge Waste Water Treatment Plant Relocation Project**  
Anglian Water Services Limited

# Design Plans – Outfall

Application Document Reference: 4.13  
PINS Project Reference: WW010003  
APFP Regulation No. 5(2)o

**Revision No. 01**  
April 2023

<b>Document title</b>	Design Plans – Outfall
<b>Version No.</b>	C01
<b>Date Approved</b>	28.01.23
<b>Date 1<sup>st</sup> Issued</b>	30.01.23

## Version History

<b>Version</b>	<b>Date</b>	<b>Author</b>	<b>Description of change</b>
C01	30.01.23	-	DCO Submission



## Contents

<b>1</b>	<b>Introduction .....</b>	<b>1</b>
----------	---------------------------	----------

## Tables

<b>Table 1-1:</b>	<b>Schedule of plans in this application document.....</b>	<b>1</b>
-------------------	--	----------

## 1 Introduction

- 1.1.1 The ‘Design Plans - Outfall’ (the Plans), listed in Table 1.1, relate to an application made by Anglian Water Services Limited (the “Applicant”) under section 37 of the Planning Act 2008 (the “2008 Act”) for a Development Consent Order (DCO) for the Cambridge Waste Water Treatment Plant Relocation Project.
- 1.1.2 The Plans are included in the DCO application in compliance with Regulation 5(2)(o) of the Infrastructure Planning (Applications: Prescribed Forms and Procedure) Regulations 2009 (the “2009 Regulations”), which require:
- “5(2) The application must be accompanied by—*
- (o) “any other plans, drawings and sections necessary to describe the proposals for which development consent is sought, showing details of design, external appearance, and the preferred layout of buildings or structures, drainage, surface water management, means of vehicular and pedestrian access, any car parking to be provided, and means of landscaping;”*
- 1.1.3 As these Plans are part of the application documentation, they should be read alongside and are informed by the other application documentation. In particular, these Plans should be read alongside Schedule 1 (Authorised Development) of the Draft Development Consent Order (Application Document Reference 2.1) and the Works Plans (Application Document Reference 4.3).

**Table 1-1: Schedule of plans in this application document**

Application Document Ref	Document Title	Drawing Number	Revision	Status
4.13.1	4.13.1 Design Plans – Outfall & Effluent Storm Pipeline Plans: Outfall Final Effluent Longitudinal Section	00001-100006- CAMEST-ZZZ- LON-C-9803	CO1	S4
4.13.2	4.13.2 Design Plans – Outfall & Effluent Storm Pipeline Plans: Outfall Storm Pipeline Longitudinal Section	00001-100006- CAMEST-ZZZ- LON-C-9804	CO1	S4
4.13.3	4.13.3 Design Plans – Outfall Outfall Layout Plan	00001-100006- CAMEST-ZZZ- LAY-Z-9817	CO1	S4
4.13.4	4.13.4 Design Plans – Outfall Outfall Cross Sections	00001-100006- CAMEST-ZZZ- LON-C-9805	CO1	S4
4.13.5	4.13.5 Design Plans – Outfall Outfall River Frontage	00001-100006- CAMEST-ZZZ- LON-C-9806	CO1	S4

GENERAL NOTES

- ALL DIMENSIONS ARE INDICATIVE AND FINAL DIMENSIONS ARE SUBJECT TO DETAILED DESIGN DEVELOPMENT.

LEGEND

- PUBLIC RIGHTS OF WAY (EXISTING)
- PROPOSED TWIN 500mm DIAMETER POLYETHYLENE RISING MAINS BY OPEN CUT (INDICATIVE ALIGNMENT)
- PROPOSED TWIN 500mm DIAMETER POLYETHYLENE RISING MAINS BY DIRECTIONAL DRILL (INDICATIVE ALIGNMENT)
- PROPOSED Ø1500mm FINAL EFFLUENT PIPELINE (INDICATIVE ALIGNMENT)
- PROPOSED Ø1800mm STORM PIPELINE (INDICATIVE ALIGNMENT)
- EXISTING GROUND LEVEL
- PROPOSED GROUND LEVEL
- Ø DIAMETER
- ID INTERNAL DIAMETER
- FE FINAL EFFLUENT
- ST STORM FLOW
- MH MANHOLE

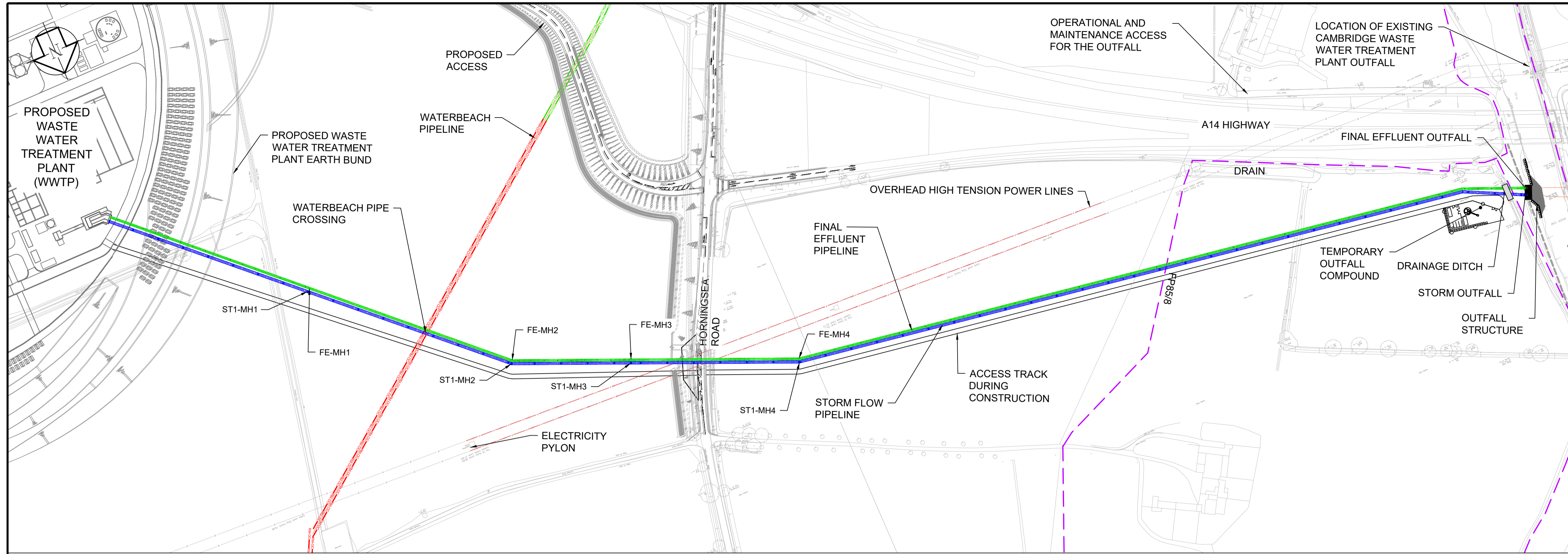

PLAN  
SCALE 1:2000

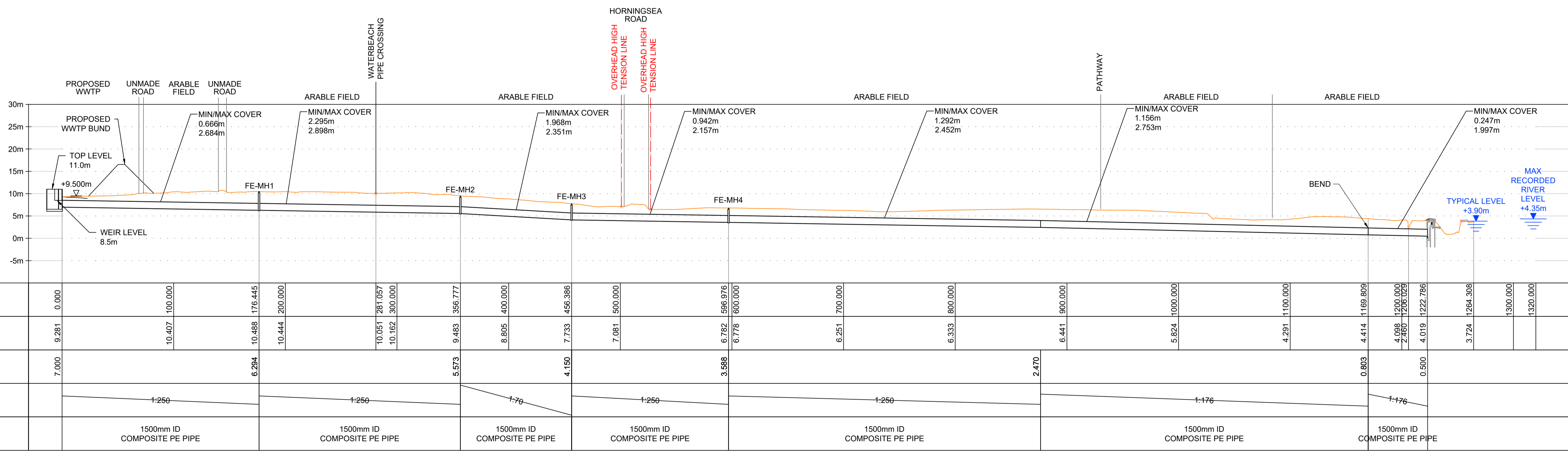

LONGITUDINAL SECTION - PROPOSED FINAL EFFLUENT GRAVITY MAIN - 0.00m TO 1320.00m  
SCALE: HORIZONTAL 1:2000, VERTICAL 1:500.

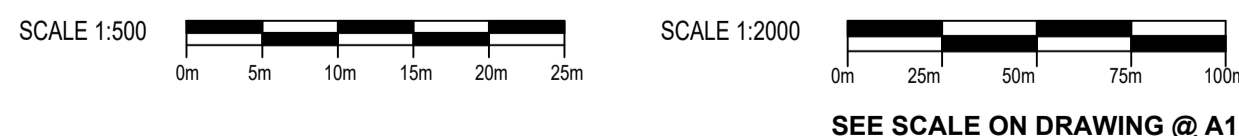

DES'D: BS	DATE: 20/01/23	SCALE: AS SHOWN
DRAWN: JL	DATE: 20/01/23	
CHK'D: MR	DATE: 20/01/23	
APP'D: MH	DATE: 20/01/23	

STAT	BY	CHK	APP
S4	JL	MR	MH

PROJECT TITLE  
**CAMBRIDGE WASTE WATER TREATMENT PLANT RELOCATION PROJECT**

DRAWING TITLE  
**4.13.1 DESIGN PLANS - OUTFALL & EFFLUENT STORM PIPELINE PLANS FINAL EFFLUENT LONGITUDINAL SECTION REGULATION 5(2)(o)**



The plan is produced by Anglian Water Services Limited, from Ordnance Survey Crown Copyright, Licence 100022432. This map is to be used for the purposes of viewing the location of Anglian Water plant only. Any other use of the map data or further copies are not permitted. This notice is not intended to exclude or restrict liability for death or personal injury resulting from negligence. The original document stored in the BIM 360 Doc Project carry the version, suitability code, revision and approval information. Prints are uncontrolled and shall not be used for construction.

DRAWING No. **00001-100006-CAMEST-ZZZ-LON-C-9803**

REV. STAT. **A1**  
C01 S4

GENERAL NOTES

- ALL DIMENSIONS ARE INDICATIVE AND FINAL DIMENSIONS ARE SUBJECT TO DETAILED DESIGN DEVELOPMENT.

LEGEND

- PUBLIC RIGHTS OF WAY (EXISTING)
- PROPOSED TWIN 500mm DIAMETER POLYETHYLENE RISING MAINS BY OPEN CUT (INDICATIVE ALIGNMENT)
- PROPOSED TWIN 500mm DIAMETER POLYETHYLENE RISING MAINS BY DIRECTIONAL DRILL (INDICATIVE ALIGNMENT)
- PROPOSED Ø1500mm FINAL EFFLUENT PIPELINE (INDICATIVE ALIGNMENT)
- PROPOSED Ø1800mm STORM PIPELINE (INDICATIVE ALIGNMENT)
- EXISTING GROUND LEVEL
- PROPOSED GROUND LEVEL
- DIAMETER
- INTERNAL DIAMETER
- FINAL EFFLUENT
- STORM FLOW
- MANHOLE

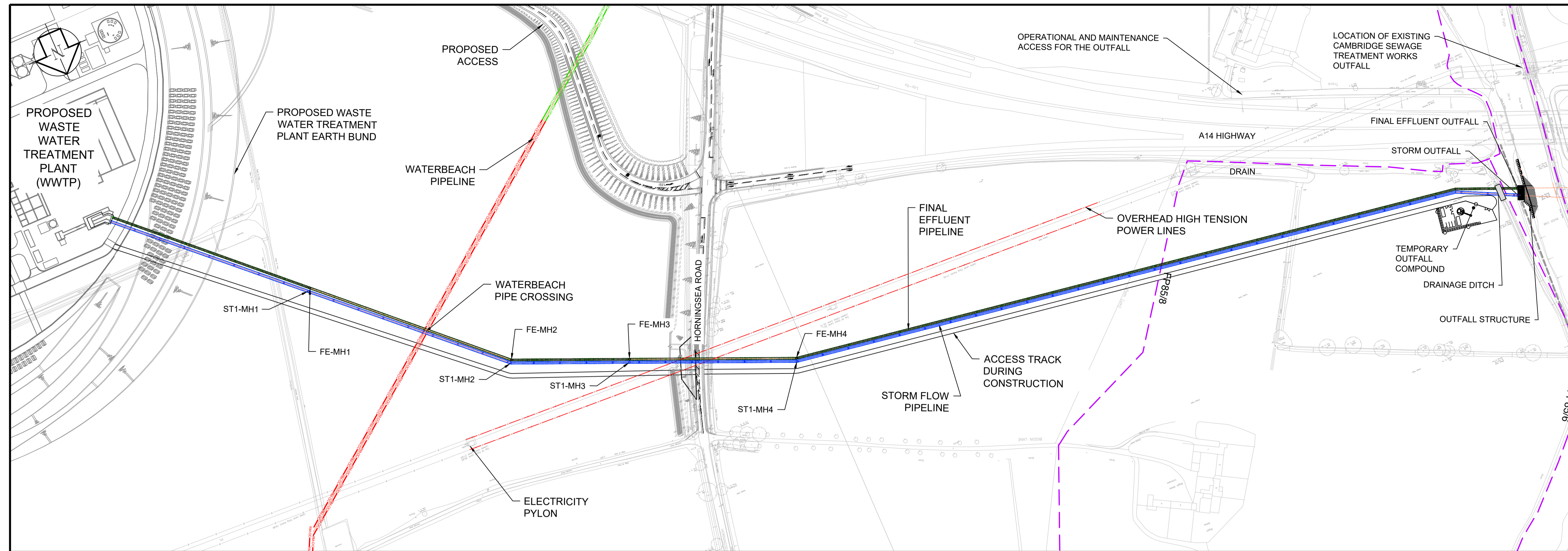

PLAN  
SCALE 1:2000

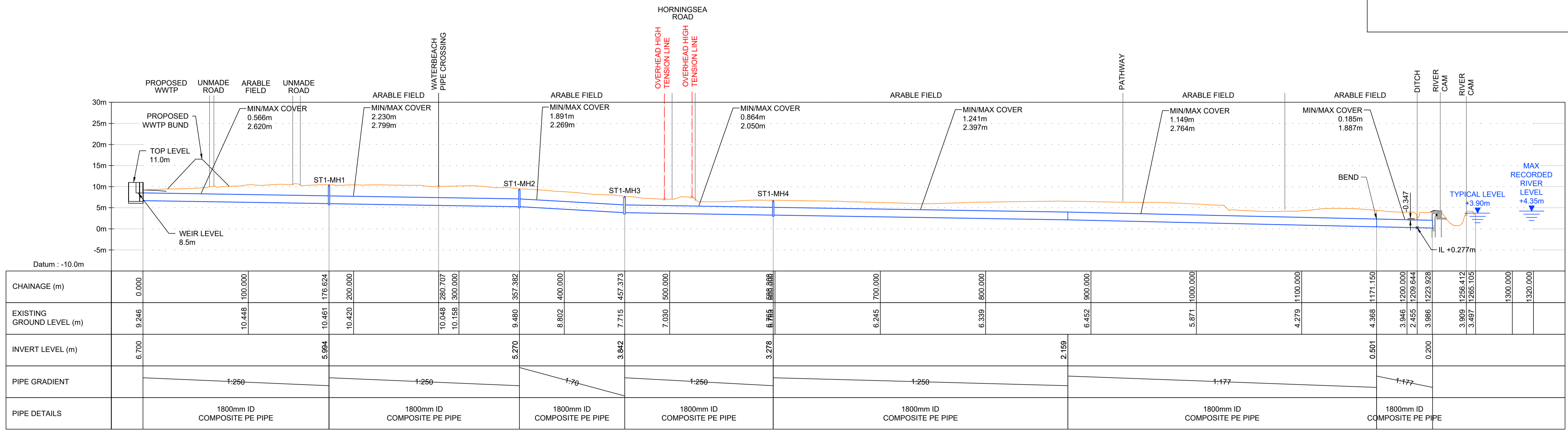

LONGITUDINAL SECTION - STORM PIPE 1 GRAVITY MAIN - 0.00m TO 1320.00m  
SCALE: HORIZONTAL 1:2000; VERTICAL 1:500



SEE SCALE ON DRAWING @ A1

DES'D: BS	DATE: 20/01/23	SCALE: AS SHOWN	PROJECT TITLE
DRAWN: JL	DATE: 20/01/23		CAMBRIDGE WASTE WATER TREATMENT PLANT RELOCATION PROJECT
CHK'D: MR	DATE: 20/01/23		4.13.2 DESIGN PLANS - OUTFALL & EFFLUENT STORM PIPELINE PLANS
APP'D: MH	DATE: 20/01/23		STORM PIPELINE LONGITUDINAL SECTION REGULATION 5(2)(o)
C01	20/01/23	FOR DCO SUBMISSION	
REV	DATE	DETAILS	

ANGLIAN WATER	Anglian Water Services Ltd, Lancaster House, Lancaster Way, Ermine Business Park, Huntingdon, PE29 6XU Tel: 01480 323000 www.anglianwater.co.uk
---------------	--

<p>The plan is produced by Anglian Water Services Limited, from Ordnance Survey Crown Copyright, Licence 100022432. This map is to be used for the purposes of viewing the location of Anglian Water plant only. Any other use of the map data or further copies are not permitted. This notice is not intended to exclude or restrict liability for death or personal injury resulting from negligence. The original document stored in the BIM 360 Doc Project carry the version, suitability code, revision and approval information. Prints are uncontrolled and shall not be used for construction.</p>	<p>DRAWING No. 00001-100006-CAMEST-ZZZ-LON-C-9804</p>	<p>DRAWING SIZE: A1</p>
<p>REV. C01</p>	<p>STAT. S4</p>	<p>REVISIONS</p>



GENERAL NOTES

- ALL DIMENSIONS ARE INDICATIVE AND FINAL DIMENSIONS ARE SUBJECT TO DETAILED DESIGN DEVELOPMENT.

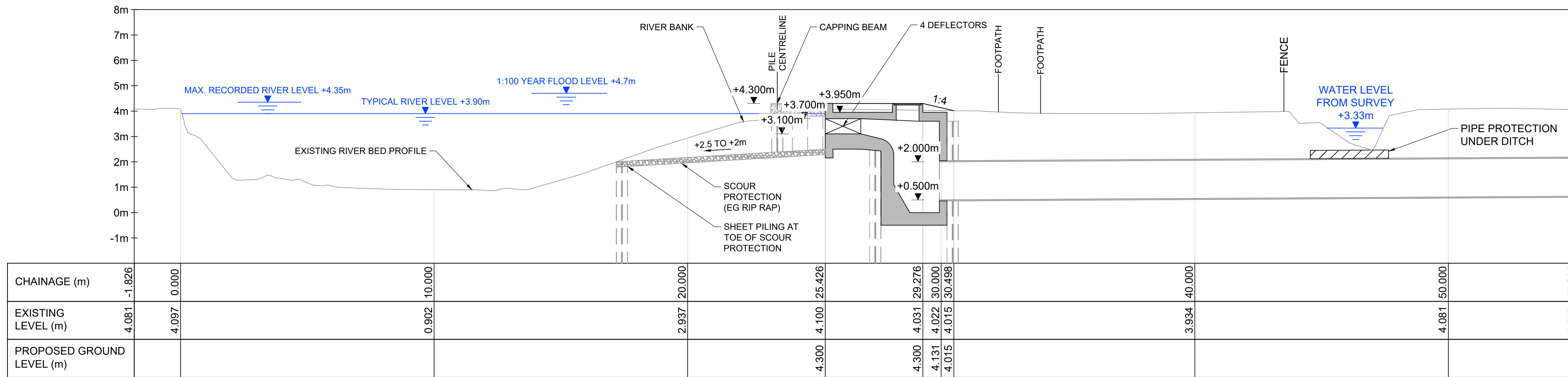

SECTION A-A (FINAL EFFLUENT OUTFALL)  
SCALE: HORIZONTAL 1:100, VERTICAL 1:100.

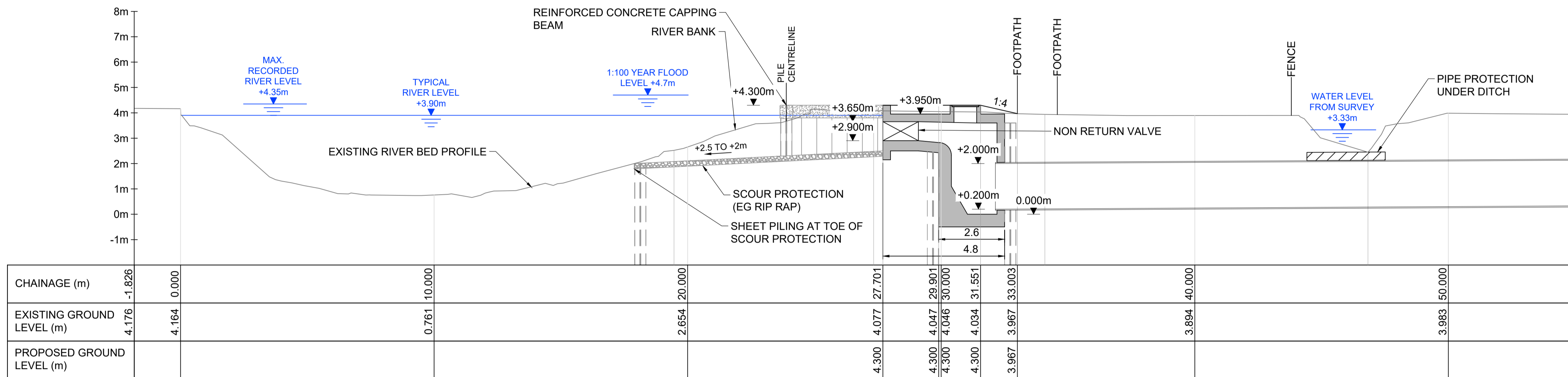

SECTION B-B (STORM OUTFALL)  
SCALE: HORIZONTAL 1:100, VERTICAL 1:100.

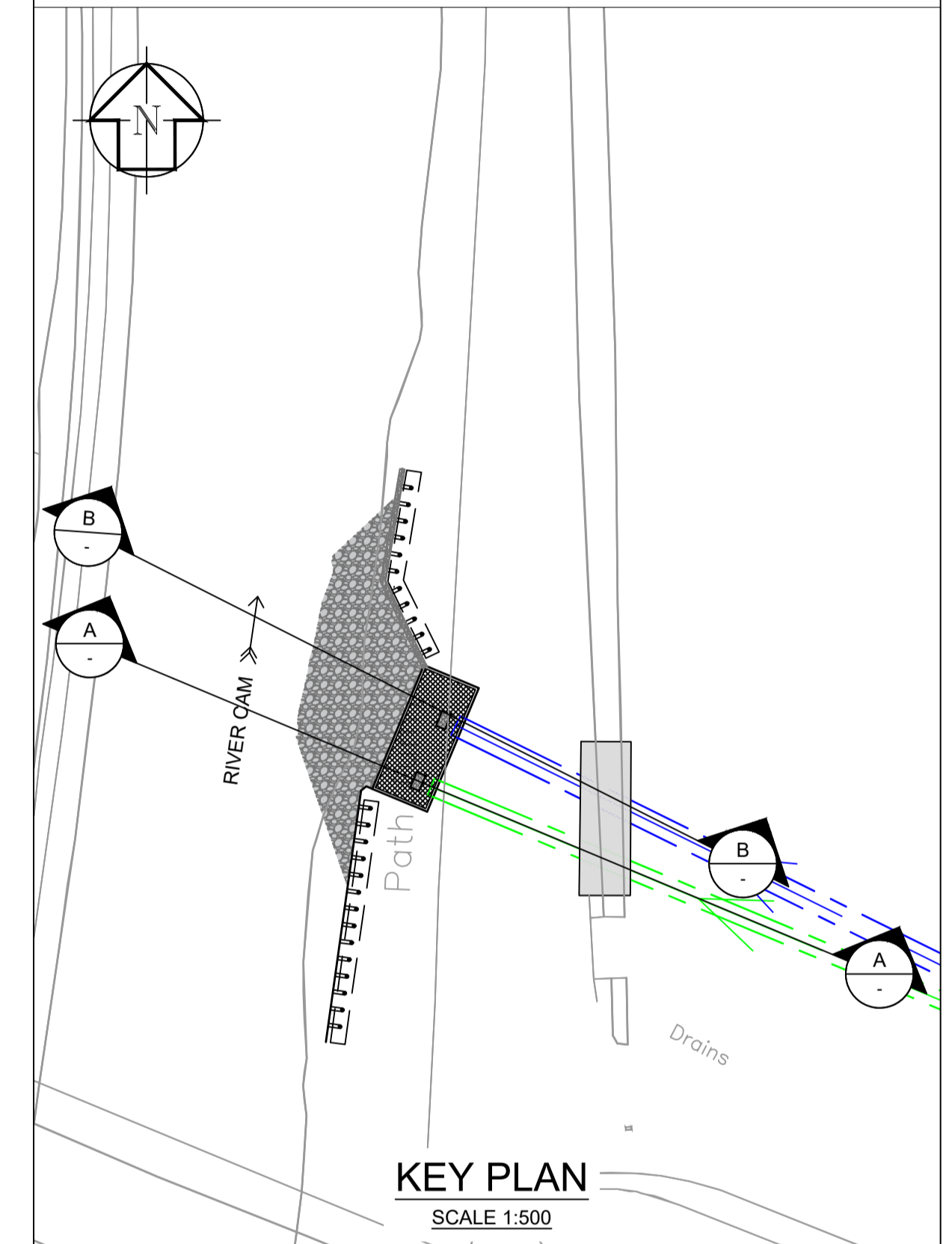

LEGEND

- PROPOSED Ø1500mm FINAL EFFLUENT PIPELINE (INDICATIVE ALIGNMENT)
- PROPOSED Ø1800mm STORM PIPELINE (INDICATIVE ALIGNMENT)
- Ø DIAMETER

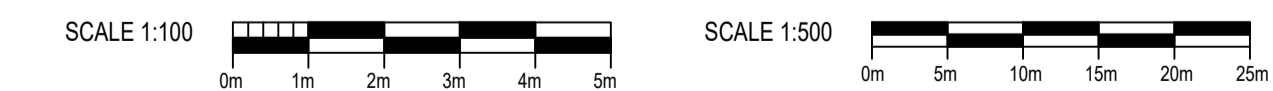

SEE SCALE ON DRAWING @ A1

DES'D: BS	DATE: 20/01/23	SCALE: AS SHOWN	PROJECT TITLE	DRAWING TITLE
DRAWN: JL	DATE: 20/01/23		CAMBRIDGE WASTE WATER TREATMENT PLANT RELOCATION PROJECT	4.13.4 DESIGN PLANS - OUTFALL OUTFALL CROSS SECTIONS REGULATION 5(2)(o)
CHK'D: MR	DATE: 20/01/23			
APP'D: MH	DATE: 20/01/23			
REV	DATE	DETAILS	STAT BY	CHK APP
C01	20/01/23	FOR DCO SUBMISSION	S4	JL MR MH

**anglianwater**

Anglian Water Services Ltd, Lancaster House, Lancaster Way, Ermine Business Park, Huntingdon, PE29 6XU  
Tel: 01480 323000 www.anglianwater.co.uk

The plan is produced by Anglian Water Services Limited, from Ordnance Survey Crown Copyright, Licence 100022432. This map is to be used for the purposes of viewing the location of Anglian Water plant only. Any other use of the map data or further copies are not permitted. This notice is not intended to exclude or restrict liability for death or personal injury resulting from negligence. The original document stored in the BIM 360 Doc Project carry the version, suitability code, revision and approval information. Prints are uncontrolled and shall not be used for construction.

DRAWING No. **00001-100006-CAMEST-ZZZ-LON-C-9805**

REV. STAT. **C01 S4**



GENERAL NOTES

1. ALL DIMENSIONS ARE INDICATIVE AND FINAL DIMENSIONS ARE SUBJECT TO DETAILED DESIGN DEVELOPMENT.
2. OUTLET LEVELS SUBJECT TO DETAILED DESIGN.

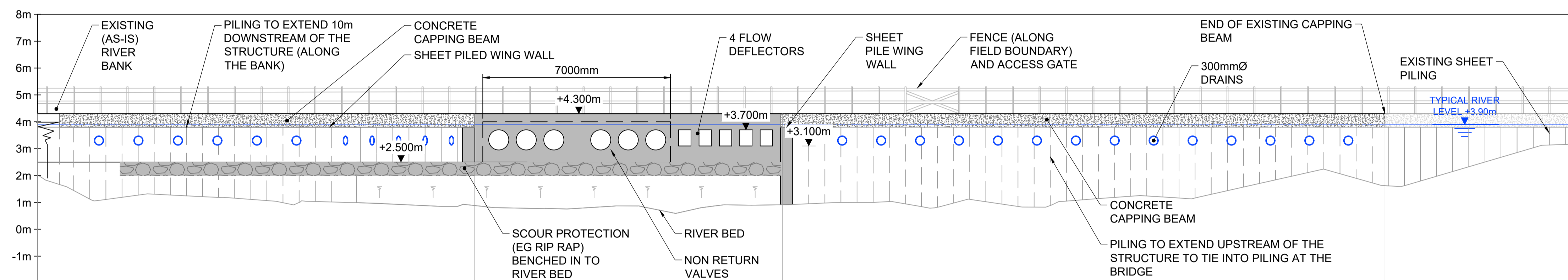

CHAINAGE (m)	-16.000	0.300	11.770	34.227
EXISTING BED LEVEL (m)	1.993	0.883	0.913	1.624
PROPOSED GROUND LEVEL (m)	4.300	4.300	4.300	4.300

OUTFALL FRONT ELEVATION C-C (FROM MID RIVER)  
SCALE: HORIZONTAL 1:100, VERTICAL 1:100.

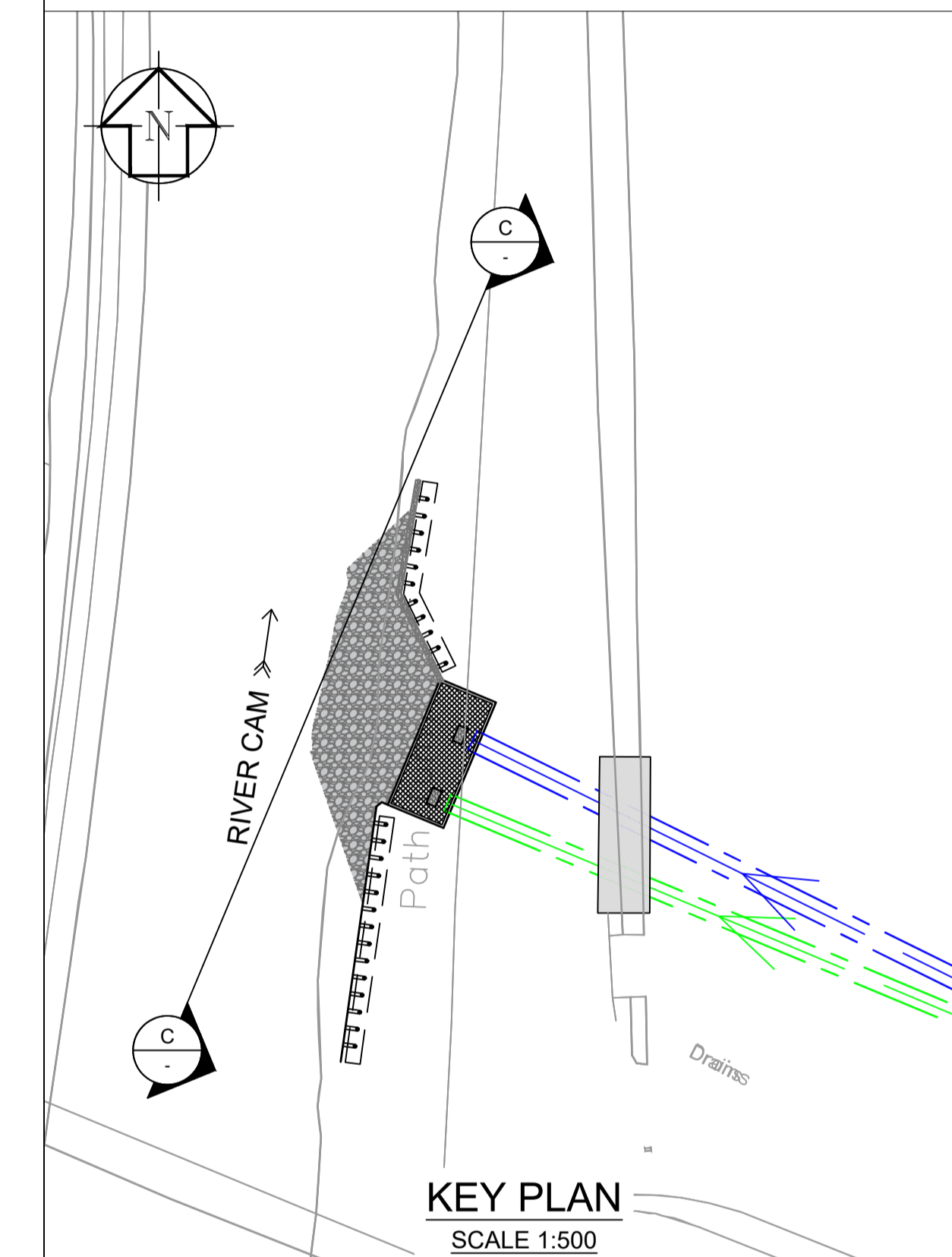

LEGEND

- PROPOSED Ø1500mm FINAL EFFLUENT PIPELINE (INDICATIVE ALIGNMENT)
- PROPOSED Ø1800mm STORM PIPELINE (INDICATIVE ALIGNMENT)
- Ø DIAMETER

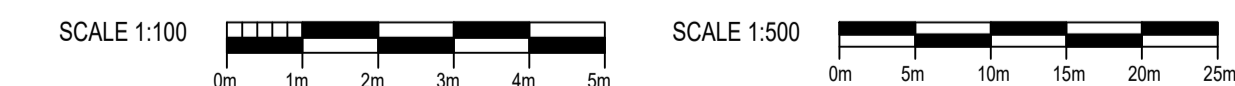

SEE SCALE ON DRAWING @ A1

DES'D: BS	DATE: 20/01/23	SCALE: AS SHOWN
DRAWN: JL	DATE: 20/01/23	
CHK'D: MR	DATE: 20/01/23	
APP'D: MH	DATE: 20/01/23	
REV	DATE	DETAILS
S4	JL	MR
STAT	BY	CHK
APP		

PROJECT TITLE	CAMBRIDGE WASTE WATER TREATMENT PLANT RELOCATION PROJECT
DRAWING TITLE	4.13.5 DESIGN PLANS - OUTFALL OUTFALL RIVER FRONTAGE REGULATION 5(2)(o)

**anglianwater**

Anglian Water Services Ltd, Lancaster House, Lancaster Way, Ermine Business Park, Huntingdon, PE29 6XU  
Tel: 01480 323000 www.anglianwater.co.uk

The plan is produced by Anglian Water Services Limited, from Ordnance Survey Crown Copyright, Licence 100022432. This map is to be used for the purposes of viewing the location of Anglian Water plant only. Any other use of the map data or further copies are not permitted. This notice is not intended to exclude or restrict liability for death or personal injury resulting from negligence. The original document stored in the BIM 360 Doc Project carry the version, suitability code, revision and approval information. Prints are uncontrolled and shall not be used for construction.

DRAWING No. 00001-100006-CAMEST-ZZZ-LON-C-9806

REV. STAT. A1 C01 S4

## Get in touch

You can contact us by:



Emailing at [info@cwwtpr.com](mailto:info@cwwtpr.com)



Calling our Freephone information line on **0808 196 1661**



Writing to us at **Freepost: CWWTPR**



Visiting our website at 

You can view all our DCO application documents and updates on the application on The Planning Inspectorate website:

<https://infrastructure.planninginspectorate.gov.uk/projects/eastern/cambridge-waste-water-treatment-plant-relocation/>